

# FLAGLER STATION

11825 NW 100 Road, Miami  
SUITE 1 & 3 - RB3



**FOR LEASE**  
**59,700 SF AVAILABLE**



## ONE BUSINESS PARK - ONE CONTACT ENDLESS POSSIBILITIES

Flagler Station is a strategically located, 9 million square foot campus style office, retail and industrial development, featuring beautiful lakefront views in a suburban atmosphere. Phase 1 consists of 2.5 million square feet of existing office and industrial space. Phase 2 totals 6.5 million square feet of new development consisting of 1.5 million square feet of office and 5 million square feet of retail and distribution space.

## PROPERTY HIGHLIGHTS

- 59,700 SF Total Available
- ±53,164 SF of Warehouse
- ±6,536 SF of Office
- 24' Clear Height
- Fully Sprinklered
- 10 Dock Doors | 6 Rail Doors
- 1 Ramp
- On-site Property Management
- On-site Park Security
- Available February 1, 2024

For more information, please contact:

**STUART T. GORDON, SIOR**  
Executive Director  
+1 305 805 5427  
stuart.gordon@cushwake.com

**MATTHEW A. BITTEL, SIOR**  
Senior Director  
+1 305 805 3032  
matthew.bittel@cushwake.com

**CUSHMAN & WAKEFIELD US, INC.**  
9960 NW 116TH Way | Suite 2  
Miami, FL 33178  
cushwakesouthfl.com | @CushWakeSouthFL

# FLAGLER STATION

11825 NW 100 Road, Miami  
**SUITE 1 & 3 - RB3**

**FOR LEASE**  
**59,700 SF AVAILABLE**

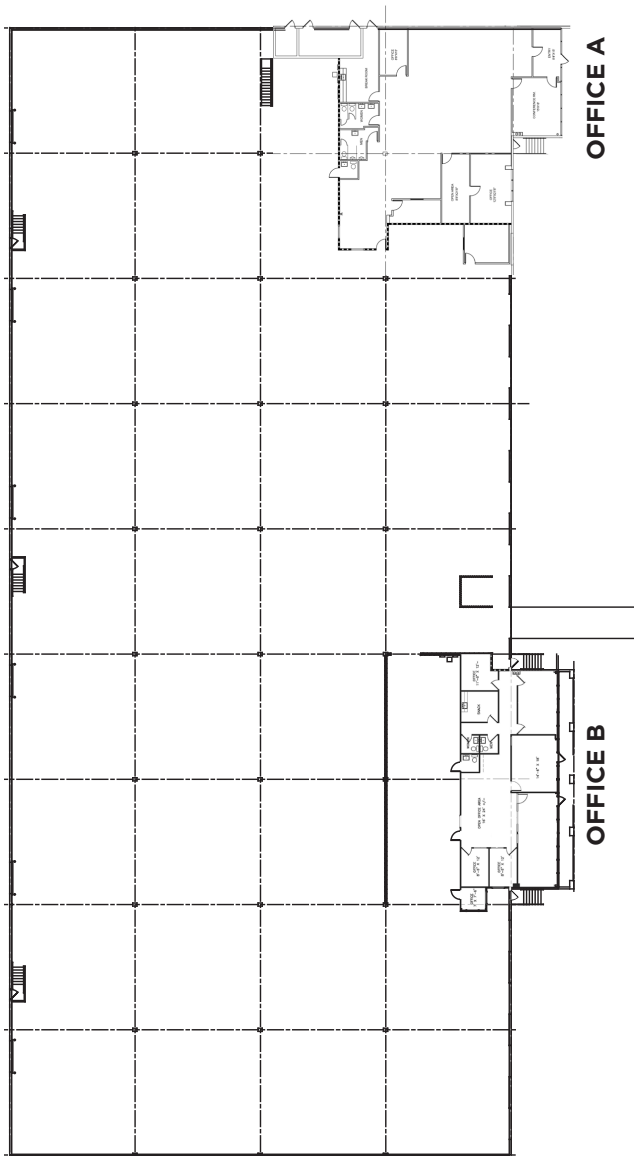

PROPERTY HIGHLIGHTS	
TOTAL AVAILABLE	±59,700 SF
WAREHOUSE SIZE	±53,164 SF
OFFICE SIZE	±6,536 SF
OFFICE A	±4,281 SF
OFFICE B	±2,255 SF
DOCK DOORS   RAMP   RAIL	10 / 1 / 6

## Phase I



For more information, please contact:

**STUART T. GORDON, SIOR**  
 Executive Director  
 +1 305 805 5427  
 stuart.gordon@cushwake.com

**MATTHEW A. BITTEL, SIOR**  
 Senior Director  
 +1 305 805 3032  
 matthew.bittel@cushwake.com



**CUSHMAN & WAKEFIELD US, INC.**  
 9960 NW 116TH Way | Suite 2  
 Miami, FL 33178

cushwakesouthfl.com | [@CushWakeSouthFL](https://twitter.com/CushWakeSouthFL)

©2023 Cushman & Wakefield. All rights reserved. The information contained in this communication is strictly confidential. This information has been obtained from sources believed to be reliable but has not been verified. NO WARRANTY OR REPRESENTATION, EXPRESS OR IMPLIED, IS MADE AS TO THE CONDITION OF THE PROPERTY (OR PROPERTIES) REFERENCED HEREIN OR AS TO THE ACCURACY OR COMPLETENESS OF THE INFORMATION CONTAINED HEREIN, AND SAME IS SUBMITTED SUBJECT TO ERRORS, OMISSIONS, CHANGE OF PRICE, RENTAL OR OTHER CONDITIONS, WITHDRAWAL WITHOUT NOTICE, AND TO ANY SPECIAL LISTING CONDITIONS IMPOSED BY THE PROPERTY OWNER(S). ANY PROJECTIONS, OPINIONS OR ESTIMATES ARE SUBJECT TO UNCERTAINTY AND DO NOT SIGNIFY CURRENT OR FUTURE PROPERTY PERFORMANCE.