

FLAGLER STATION

9710 NW 110 Avenue, Miami
SUITE 19 - BUILDING 28



FOR LEASE
37,446 SF AVAILABLE



ONE BUSINESS PARK ENDLESS POSSIBILITIES

Flagler Station is a strategically located, 9 million square foot campus style office, retail and industrial development, featuring beautiful lakefront views in a suburban atmosphere. Phase 1 consists of 2.5 million square feet of existing office and industrial space. Phase 2 totals 6.5 million square feet of development consisting of 1.5 million square feet of office and 5 million square feet of retail and distribution space.

PROPERTY HIGHLIGHTS

- ± 32,031 SF of Warehouse
- ± 5,415 SF of Office
- 24' Clear Height
- Rear Load Building
- ESFR Sprinklers
- 9 Dock Doors (One 22' Double-Wide Door)
- 1 Ramp
- Truck Court 210' / Building Depth 220'
- On-site property management & security
- Available: May 2022
- Rate: Call for more information

For more information, please contact:

STUART T. GORDON, SIOR
Executive Director
+1 305 805 5427
stuart.gordon@cushwake.com

MATTHEW A. BITTEL, SIOR
Director
+1 305 805 3032
matthew.bittel@cushwake.com

CUSHMAN & WAKEFIELD US, INC.
9960 NW 116TH Way, Suite 2
Miami, FL 33178
cushwakesouthfl.com | @CushWakeSouthFL

FLAGLER STATION

9710 NW 110 Avenue, Miami
SUITE 19 - BUILDING 28

FOR LEASE
37,446 SF AVAILABLE

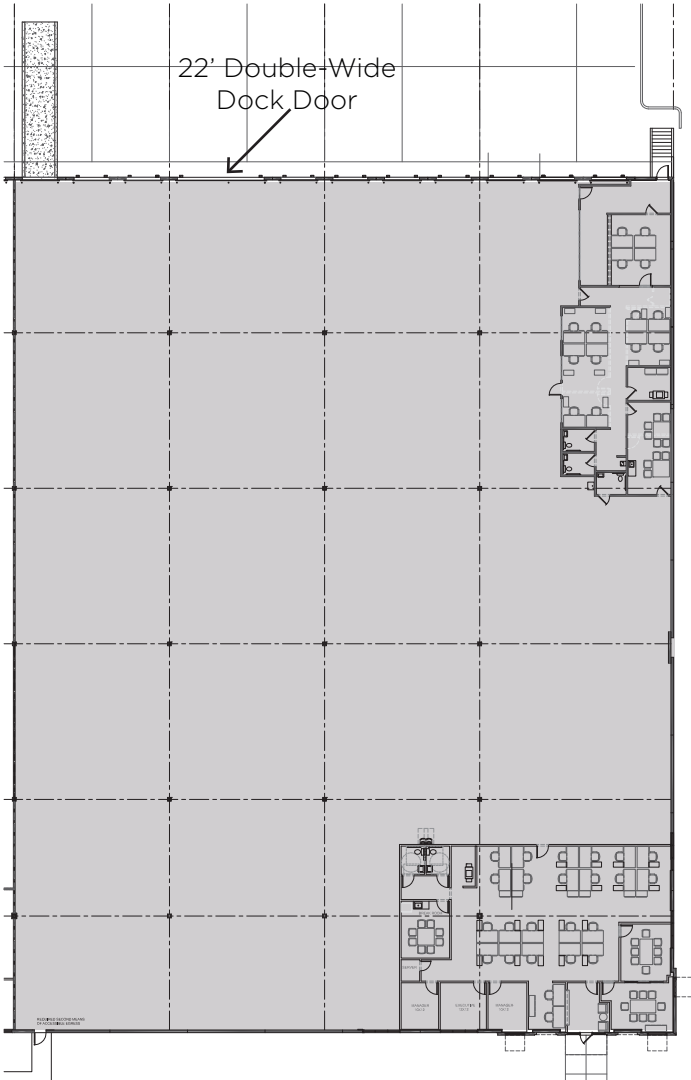

| PROPERTY HIGHLIGHTS | |
|---------------------|-----------------------------------------|
| TOTAL AVAILABLE | ±37,446 SF |
| WAREHOUSE SIZE | ±32,031 SF |
| OFFICE SIZE | ±5,415 SF A. 3,342 SF B. 2,073 SF |
| DOCK DOORS | 9 (One 22' Double-wide - 10 positions) |
| RAMP | 1 |

Phase II

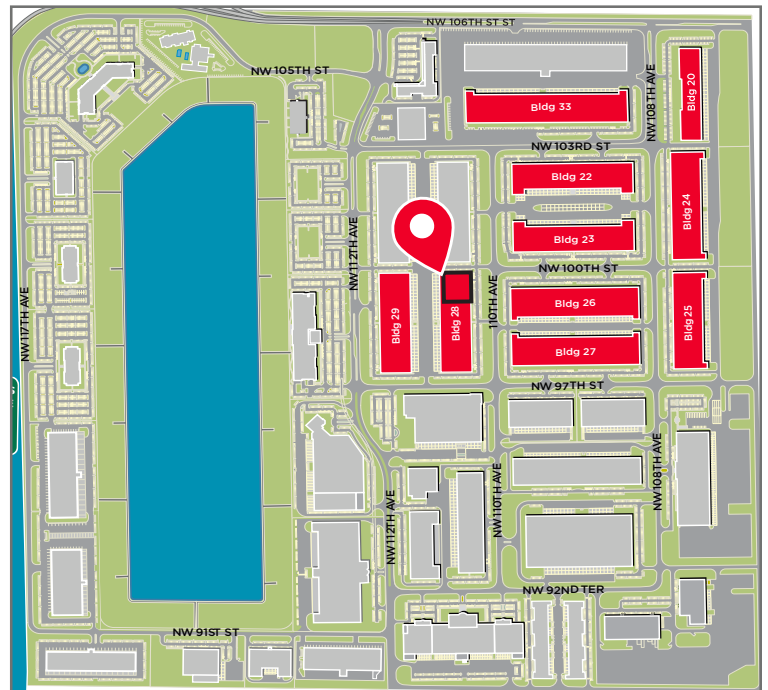

For more information, please contact:

STUART T. GORDON, SIOR
 Executive Director
 +1 305 805 5427
 stuart.gordon@cushwake.com

MATTHEW A. BITTEL, SIOR
 Director
 +1 305 805 3032
 matthew.bittel@cushwake.com



CUSHMAN & WAKEFIELD US, INC.
 9960 NW 116TH Way, Suite 2
 Miami, FL 33178
 cushwakesouthfl.com | @CushWakeSouthFL

©2022 Cushman & Wakefield. All rights reserved. The information contained in this communication is strictly confidential. This information has been obtained from sources believed to be reliable but has not been verified. NO WARRANTY OR REPRESENTATION, EXPRESS OR IMPLIED, IS MADE AS TO THE CONDITION OF THE PROPERTY (OR PROPERTIES) REFERENCED HEREIN OR AS TO THE ACCURACY OR COMPLETENESS OF THE INFORMATION CONTAINED HEREIN, AND SAME IS SUBMITTED SUBJECT TO ERRORS, OMISSIONS, CHANGE OF PRICE, RENTAL OR OTHER CONDITIONS, WITHDRAWAL WITHOUT NOTICE, AND TO ANY SPECIAL LISTING CONDITIONS IMPOSED BY THE PROPERTY OWNER(S). ANY PROJECTIONS, OPINIONS OR ESTIMATES ARE SUBJECT TO UNCERTAINTY AND DO NOT SIGNIFY CURRENT OR FUTURE PROPERTY PERFORMANCE.